

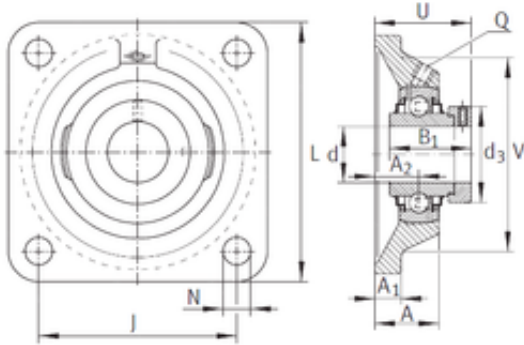

ASAHI FORGE OF AMERICA BEARING CORP.

INA RCJ2 bearing units



RCJ2 Bearing 2D drawings and 3D CAD models

Bearing No. RCJ2

Bore Diameter	50,8 mm
d	50,8 mm
V	137,008 mm
U	74,6 mm
Thread (Q)	1/8 NPT
d3	75,997 mm
A	46,99 mm
A1	16,993 mm
B	71,399 mm
J	129,997 mm
L	162,509 mm
N	16,993 mm
A2	31,013 mm
Category	Flange Block Bearings
Inventory	0.0
Manufacturer Name	SCHAEFFLER GROUP
Minimum Buy Quantity	N/A
Weight / Kilogram	4.601
Product Group	M06110
Number of Mounting Holes	4
Mounting Method	Eccentric Collar
Housing Style	4 Bolt Square Flange Block
Rolling Element	Ball Bearing
Housing Material	Cast Iron
Expansion / Non-expansion	Non-expansion
Mounting Bolts	0.669 Inch



ASAHI FORGE OF AMERICA BEARING CORP.

Relubricatable	Yes
Insert Part Number	G1200KRRB
Seals	Double Land Riding Rubber Contact
Housing Configuration	1 Piece Solid
Pilot Configuration	No Pilot
Inch - Metric	Inch
Long Description	4 Bolt Square Flange Block; 2" Bore; 7.2" Bolt Circle; 5.118" Bolt Spacing; 1 Piece Solid; Eccentric Collar Mount; Cast Iron; Ball Bearing; 2.811" Length Thru Bore; Relubricatable;
Other Features	Single Row With Set Screw
Category	Flange Block
UNSPSC	31171501
Harmonized Tariff Code	8483.20.40.40
Noun	Bearing
Keyword String	Flanged
Manufacturer URL	http://www.ina.com
Manufacturer Item Number	RCJ2
Weight / LBS	9.041
Cartridge Pilot Depth	0 Inch 0 Millimeter
Cartridge Pilot Diameter	0 Inch 0 Millimeter
Length Thru Bore	2.811 Inch 71.4 Millimeter
Bolt Spacing	5.118 Inch 130 Millimeter
Bore	2 Inch 50.8 Millimeter
Nominal Bolt Circle Diameter Round	7.2 Inch 184 Millimeter